

Bröwnie

Architectural LED Lighting



Integrated Solution with PVC Stretch Film & V-Wide LED Module

PVC STRETCH FILM

The stretch ceiling is a decorative technique related to the use of material commonly called "canvas" which is made from the PVC. Invented in the late 1960s in Sweden, the stretch ceiling is imported and manufactured in France in the 70s.

This is a membrane fabric that is flexible and stretchable when it heats up and shrinks as it cool.

Specification

- Transmission Rate: Up to 50%.
- Weight: 180 gram/sqm (for thickness t0.18mm)
- Mechanical Properties: Tensile Strength 16.3MPa, Elongation at break 250% (ISO 527-1:2012 & ISO 527-3-1995/Cor.2:2001), Tear Strength 361N.m at X direction, 338N.m at Y Direction
- Fire retardant level: Inflammable M1 Classification (DIN EN 13501-1 Bs2 D0)
- UV Resistant.
- Installation Method: Using PVC profile (20mm x 8mm) cut into the length provided by us. (See below detail typical detail section).
- Good bending properties: suitable for Installation of light boxes with curved or circular frame.
- Able to print photos, logos and patterns of your choice.
- Fully recyclable, Water-proof, washable and impermeable to vapor.

Fire Standards and related Certificates

- | | | |
|----------------------|----------|------------------------------------|
| ➤ Fire behaviour: | Class B | (Inflammable materials) |
| ➤ Smoke development: | Class S1 | (Very limited smoke development) |
| ➤ Burning droplets: | Class d0 | (No burning droplets or particles) |

Euro Airs textile materials (HDC and DFC-line) are certified and approved according to:

B-S1, d0

**For full test report of our stretch ceiling, please contact our sales person.*

Maintenance Procedure

1. For cleaning/removing of dirt on the surface of membrane fabric

- Use a Nano fabric (Fabrics with delicate fabrics) together with Glass cleaner.
- Spray directly on the membrane and gently wipe the surface

2. For changing or troubleshooting of light source inside the light box/ceiling

- Gently and carefully remove the PVC frame and fabric material on the area that are affected and carry out the work as required
- Before installing the membrane fabric back, stretch the membrane fabric to tension it, followed by blowing hot air onto it to remove any wrinkles.
- Gently and carefully Install the membrane fabric back to the PVC frame and tension it. Blow hot air onto it to remove wrinkles if necessary.



INSTALLATION METHODS

1) Anti-Shadow Installation Frame PVC H45

ANTI-SHADOW INSTALLATION FRAME PVC H45

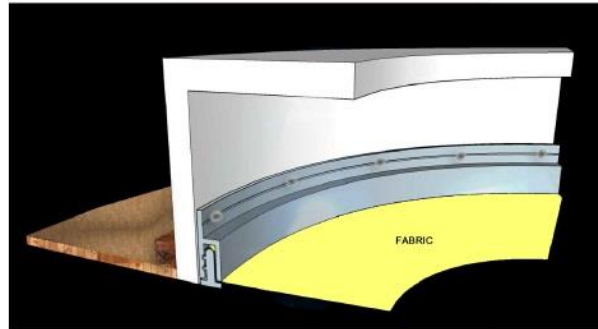
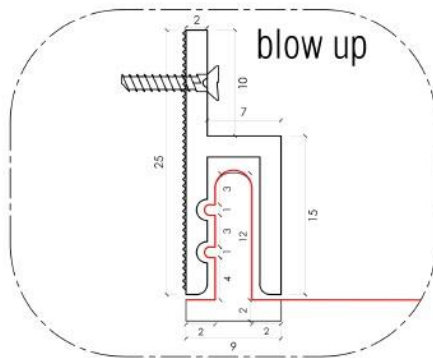
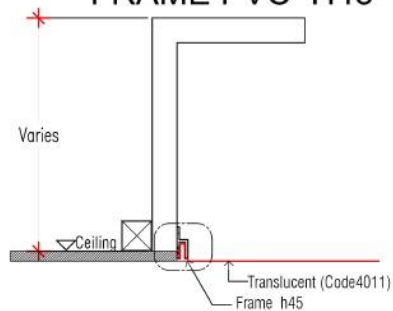

- Suitable for Installation of light boxes with curved or circular frame, as good bending properties.

2) Double Layer – Dust Proof Frame PVC E25-2

DOUBLE LAYER - DUST PROOF FRAME PVC E25-2

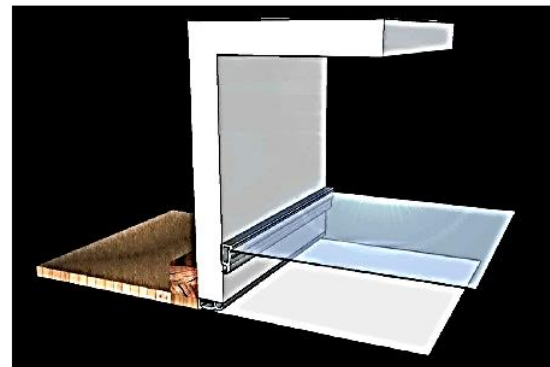
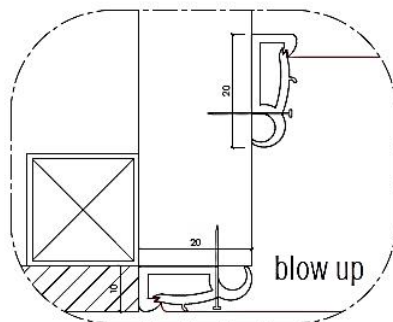
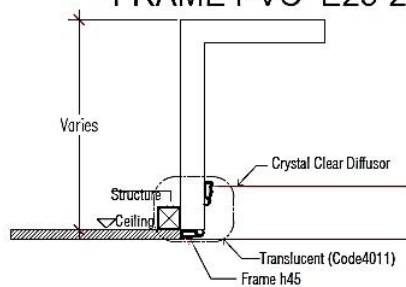

- Suitable for making light boxes, require dust proof and diffuse lighting

3) Invisible Installation Frame PVC E25

INVISIBLE INSTALLATION FRAME PVC E25

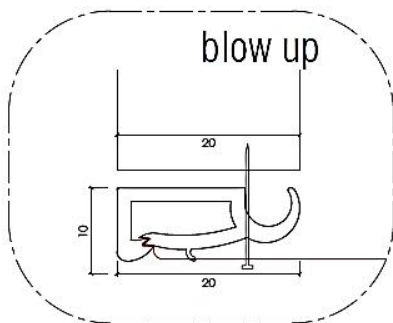
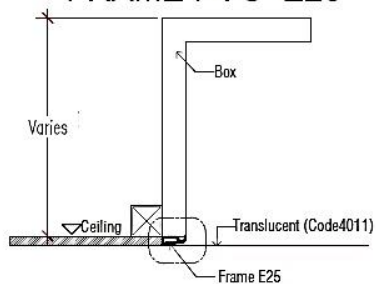

- Installation with frame PVC Install on bottom Structure's light boxes, equal with ceiling.

4) Standard Installation Aluminium Angle E35

STANDARD INSTALLATION ALUMINUM ANGLE E25

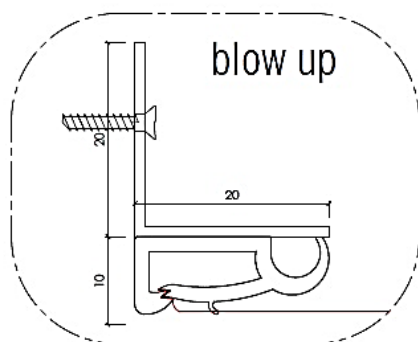
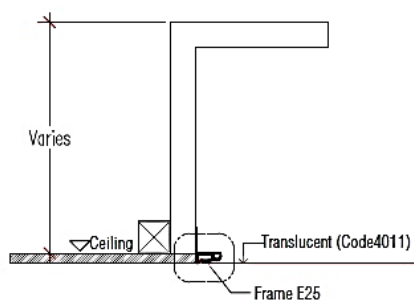

- Installation with aluminum angle and frame PVC, Install in circumference light boxes.

PVC PROFILE

Typically, the PVC profile is the preferred choice for most architects and designers, enabling curves, domes, vaults and many other shapes to be formed with ease.

Smart Clip

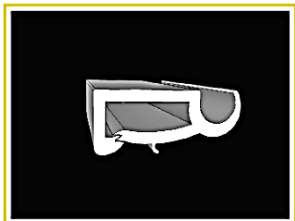

Slim PVC can maintain the membrane on tension on peripheral of the structure

H Clip

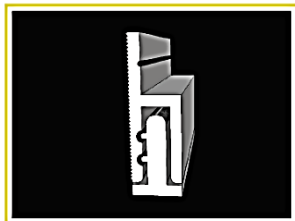

Profile clean shadow on peripheral of the structure

L Clip



Can be install on any support, wood, gypsum, steel etc...

S.O. Clip

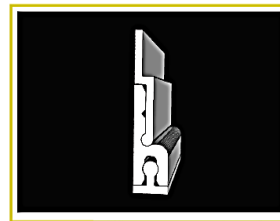

Open box by user. No intervention needed from contractor. For maintenance and cleaning operation

WHY USE BROWNIE'S STRETCH FILM?



Easy installation, dust-free, non-toxic and low maintenance.



We provide the lighting solutions, tabulations as well as site installation.



High quality (Made in Germany) and competitive pricing.



5 years maintenance-free for both LED + Stretch ceiling film.

V-WIDE LED MODULE (Available in both mono-colour white and RGBW 2700K)

Suitable for PVC Stretch Ceiling as well as lightbox and signage.



Example of V-Wide application.

Main Features

- 1ft long back-lighting module with optical lens that emits 165deg beam.
- Typical module pitch at 140mm for lightbox depth of minimum 75mm.
⇒ Box depth can be minimum 55% of the module pitch.
- Optional accessory product of PVC stretch ceiling film ("Motion-Tech" brand) using raw material from PONGS Germany that has up to 50% light transmission rate.

**For more details of V-Wide LED Module, please refer to our catalogue.*

Project References

1. National Library Singapore



2. LTA Control Room (Singapore)



3. VW Showroom at Leng Kee (Singapore)

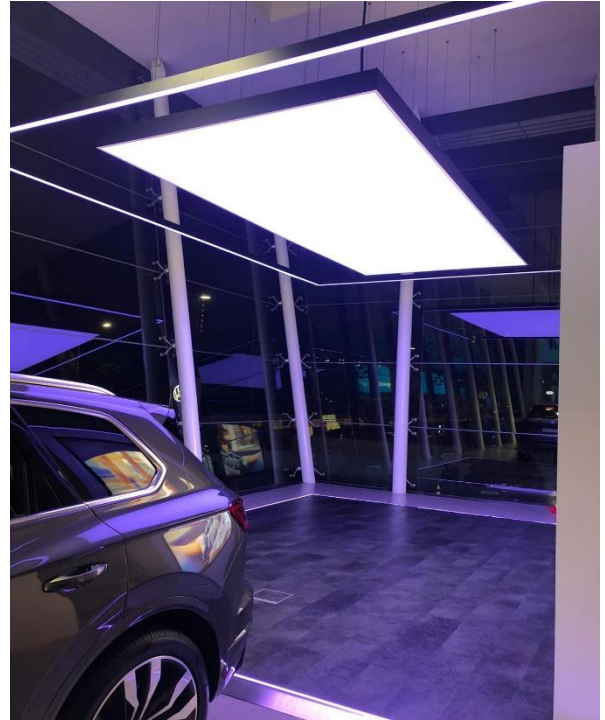

Membrane installation

Dimension : 5m x 2.2m (2 sets)

4. Office Anderson Mori & Tomotsune (Raffles Place, Singapore)



LED Fixture Used: V Wide 4000K

c/w Membrane installation

Dimension : 3.2m x 2.2m

5. Office @ Statutory Board (Singapore)



6. Shopping Mall @ Upper Changi (Singapore)



LED Fixture used: V-Wide RGB+White. Including membrane installation

7. Terminal 21 @ Korat, Thailand



8. Central World Food Hall at Bangkok



9) Other projects



**For more project references, please contact our sales person.*